

C8 UGELLI PER TUBI SPRUZZATORI SHOWER SPRAY NOZZLES BOQUILLA PARA TUBOS ROCIADORES

Caratteristiche

Dischi filettati per il montaggio su tubi spruzzatori con spazzola interna di pulizia o dove sia necessario non avere ingombri esterni.

Applicazioni

- Cartiere.
- Filtri a nastro.

Materiali

Aisi303 o Aisi316L

Characteristics

Threaded discs for assembling on shower pipes with interior cleaning brush or when the space is limited.

Applications

- Paper mills.
- Band filters.

Materials

SS303 or SS316L

Características

Discos roscados para montaje sobre tubos rociadores con cepillo interno de limpieza o donde sea necesario evitar volúmenes externos.

Aplicaciones

- Papeleras.
- Filtros de cinta.

Materiales

Aisi303 o Aisi316L

C8

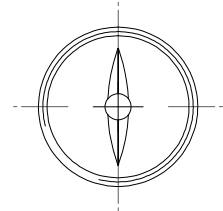
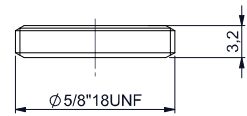

| Flow Factor | US (gpm at 40 psi) | Pressure (Bar) | | | | | | | Angle <° 3 Bar |
|-------------|--------------------|----------------|-----|-----|------|------|------|------|----------------|
| | | 1,5 | 2 | 3 | 4 | 5 | 7 | 10 | |
| | | Capacity (Lpm) | | | | | | | |
| 1 | 0,51 | 1,3 | 1,7 | 2,0 | 2,5 | 2,7 | 3,0 | 3,7 | 50 |
| 2 | 1,34 | 3,5 | 4,3 | 5,3 | 6,3 | 6,7 | 8,0 | 9,7 | 45 |
| 3 | 1,34 | 3,5 | 4,3 | 5,3 | 6,3 | 6,7 | 8,0 | 9,7 | 65 |
| 4 | 1,34 | 3,5 | 4,3 | 5,3 | 6,3 | 6,7 | 8,0 | 9,7 | 80 |
| 5 | 2,38 | 6,5 | 7,5 | 9,4 | 11,0 | 12,4 | 14,4 | 17,2 | 65 |

C9 UGELLI PER TUBI SPRUZZATORI SHOWER SPRAY NOZZLES BOQUILLA PARA TUBOS ROCIADORES

Caratteristiche

Vengono costruiti in acciaio inox AISI 303 con attacco filettato maschio da 9/16 e 1/4". L'orifizio viene fornito con diametri diversi in funzione delle caratteristiche richieste.

Applicazioni

- Tubi spruzzatori in cartiera.

Materiali

Aisi303, Aisi316L, su richiesta disponibile con inserto in rubino.

Characteristics

They are made in stainless steel AISI 303 with male thread connection 9/16 and 1/4. Different orifice diameters available depending on your specific requests.

Applications

- Shower pipes in paper mill.

Materials

SS303, SS316L, on request it's available ruby insert.

Características

Se construyen en acero inox AISI 303 con conexión roscada macho de 9/16 y 1/4". El orificio se prepara con distintos diámetros en función de las características requeridas.

Aplicaciones

- Tubos rociadores en papeleras.

Materiales

Aisi303, Aisi316L, bajo pedido es disponible inserto en rubí.

C9

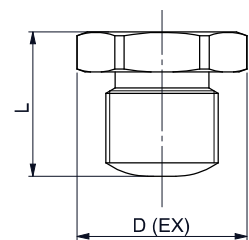

| Connection | D (EX) | L |
|------------|--------|------|
| 1/4" | 17,0 | 14,6 |
| 9/16"UNF | 17,0 | 18,0 |

| Connection | Code | Dia. (mm) | US (gpm at 40 psi) | Pressure (Bar) | | |
|------------|---------|-----------|--------------------|----------------|------|------|
| | | | | 3 | 10 | 20 |
| | | | | Capacity (Lpm) | | |
| 1/4" BSP | 1C908 | 0,8 | 0,19 | 0,75 | 1,37 | 1,94 |
| 1/4" BSPT | 1C908C | 0,9 | 0,19 | 0,75 | 1,37 | 1,94 |
| 1/4" BSP | 1C91 | 1,0 | 0,24 | 0,95 | 1,73 | 2,45 |
| 1/4" BSPT | 1C91C | 1,0 | 0,24 | 0,95 | 1,73 | 2,45 |
| 1/4" BSPT | 1C91.6C | 1,6 | 0,58 | 2,30 | 4,20 | 5,94 |
| 1/4" BSP | 1C92 | 2,0 | 0,92 | 3,65 | 6,66 | 9,42 |
| 1/4" BSPT | 1C92C | 2,0 | 0,92 | 3,65 | 6,66 | 9,42 |
| 9/16" | C907 | 0,7 | 0,14 | 0,56 | 1,02 | 1,44 |
| 9/16" | C908 | 0,8 | 0,19 | 0,75 | 1,37 | 1,94 |
| 9/16" | C91 | 1 | 0,24 | 0,95 | 1,73 | 2,45 |
| 9/16" | C91.2 | 1,2 | 0,32 | 1,27 | 2,31 | 2,58 |
| 9/16" | C92 | 2 | 0,92 | 3,65 | 6,66 | 9,42 |