

# BG Series Inline Entry Hollow Cone Spray Nozzles

**BG**

Inline Entry Hollow Cone Spray pattern with uniform distribution of finely atomized droplets. Smaller droplets in spray pattern than full cone nozzles of the same capacity at similar pressures.

**Design** : One piece in-line body with removable orifice tip, two piece construction

**Application** : Gas Cooling & Cleaning, Spray drying, Desuperheating, Water Cooling, Fugitive Dust suppression.

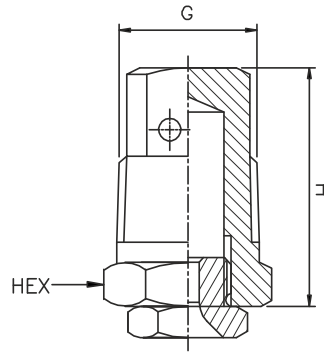

MODEL NO.	END CONNECTION (G)					Inlet Dia. Nom. (mm)	ORIFICE SIZE (mm)	FLOW CAPACITY IN LPM AT DIFFERENT PRESSURE VALUES								MATERIAL CODE				
	YB	YC	YD	YE	YH			Pressure [bar]								M1/M2	M3	P1/P2		
<b>60° SPRAY ANGLE</b>	1/4"BSPT	3/8"BSPT	1/2"BSPT	3/4"BSPT	1 1/2"BSPT			Flow Capacity in GPM										SS304/SS316	Brass	PVC/PP
									40°psi	0.5	1.0	2.0	3.0	5.0	7.0	10.0				
BG14.050						1.2	1.1	0.15	0.25	0.35	0.50	0.61	0.79	0.94	1.12		H	HEX		
BG14.075	YB					1.4	1.3	0.23	0.37	0.53	0.75	0.92	1.19	1.40	1.68		25	14		
BG14.100	YB					1.7	1.6	0.31	0.5	0.71	1.00	1.22	1.58	1.87	2.24		Weight (Metals) = 20.9 gms. Approx			
BG14.150	YB	YC				2.1	2.0	0.46	0.75	1.06	1.50	1.84	2.37	2.81	3.35					
BG14.175	YB	YC				2.2	2.1	0.54	0.87	1.24	1.75	2.14	2.77	3.27	3.91		YC			
BG14.200	YB	YC				2.4	2.3	0.61	1.00	1.41	2.00	2.45	3.16	3.74	4.47		27	17		
BG14.250	YB	YC				2.7	2.5	0.77	1.25	1.77	2.50	3.06	3.95	4.68	5.59		Weight (Metals) = 33.3 gms. Approx			
BG14.350		YC				3.2	3.0	1.07	1.75	2.47	3.50	4.29	5.53	6.55	7.83					
BG14.400		YC				3.4	3.2	1.23	2.00	2.83	4.00	4.90	6.32	7.48	8.94					
BG14.475		YC				3.7	3.5	1.46	2.37	3.36	4.75	5.82	7.51	8.89	10.62					
BG14.650		YC	YD			4.3	4.1	1.99	3.25	4.60	6.50	7.96	10.28	12.16	14.53		YD			
BG14.800		YC	YD			4.8	4.5	2.45	4.00	5.66	8.00	9.80	12.65	14.97	17.89		32.5	22		
BG24.100			YD			5.4	5.1	3.07	5.00	7.07	10.00	12.25	15.81	18.71	22.36		Weight (Metals) = 60.1 gms. Approx			
BG24.125			YD			6.0	5.7	3.83	6.25	8.84	12.50	15.31	19.76	23.39	27.95					
BG24.160			YD			6.8	6.4	4.90	8.00	11.31	16.00	19.60	25.30	29.93	35.78					
<b>75° SPRAY ANGLE</b>																				
BG15.150		YC				2.1	2.0	0.46	0.75	1.06	1.50	1.84	2.37	2.81	3.35		YC			
BG15.175		YC				2.2	2.1	0.54	0.875	1.24	1.75	2.14	2.77	3.27	3.91		27	17		
BG15.200		YC				2.4	2.3	0.61	1.00	1.41	2.00	2.45	3.16	3.74	4.47		Weight (Metals) = 33.3 gms. Approx			
BG15.250		YC				2.7	2.5	0.77	1.25	1.77	2.50	3.06	3.95	4.68	5.59					
BG15.350		YC				3.2	3.0	1.07	1.75	2.47	3.50	4.29	5.53	6.55	7.83					
BG15.400		YC				3.4	3.2	1.23	2.00	2.83	4.00	4.90	6.32	7.48	8.94					
BG15.475		YC	YD			3.7	3.5	1.46	2.37	3.36	4.75	5.82	7.51	8.89	10.62					
BG15.650		YC	YD			4.3	4.1	1.99	3.25	4.60	6.50	7.96	10.28	12.16	14.53					
BG15.800		YC	YD			4.8	4.5	2.45	4.00	5.66	8.00	9.80	12.65	14.97	17.89					
BG15.100			YD	YE		5.4	5.1	3.07	5.00	7.07	10.00	12.25	15.81	18.71	22.36		YE			
BG15.120			YD	YE		6.0	5.7	3.83	6.25	8.84	12.50	15.31	19.76	23.39	27.95		38	27		
BG15.160			YD	YE		6.8	6.4	4.90	8.00	11.31	16.00	19.60	25.30	29.93	35.78		Weight (Metals) = 63.0 gms. Approx			
BG15.200				YE		7.6	7.2	6.13	10.00	14.14	20.00	24.49	31.62	37.42	44.72					
BG15.225				YE		8.1	7.6	6.90	11.25	15.91	22.50	27.56	35.58	42.09	50.31					
BG15.250				YE		8.5	8.0	7.66	12.5	17.68	25.00	30.62	39.53	46.77	55.90					
BG15.320				YE		9.6	9.1	9.81	16.00	22.63	32.00	39.19	50.60	59.87	71.55					
<b>90° SPRAY ANGLE</b>																				
BG26.320					YH	9.6	9.1	9.81	16.00	22.63	32.00	39.19	50.60	59.87	71.55		YH			
BG26.400					YH	10.8	10.1	12.26	20.00	28.28	40.00	48.99	63.25	74.83	89.44		60.5	51		
BG26.520					YH	12.3	11.5	15.94	26.00	36.77	52.00	63.69	82.22	97.28	116.28		Weight (Metals) = 595 gms. Approx			
BG26.650					YH	13.7	12.9	19.92	32.5	45.96	65.00	79.61	102.77	121.60	145.34					
BG26.800					YH	15.2	14.3	24.52	40.00	56.57	80.00	97.98	126.49	149.67	178.89					